

TOOLS REQUIRED:
 Cordless Drill W/ #2 Square-Recess Bit &
 #2 Phillips Head Bit
 11/32" or 9mm wrench

GLUE STRIPS WITH GLUE DOTS

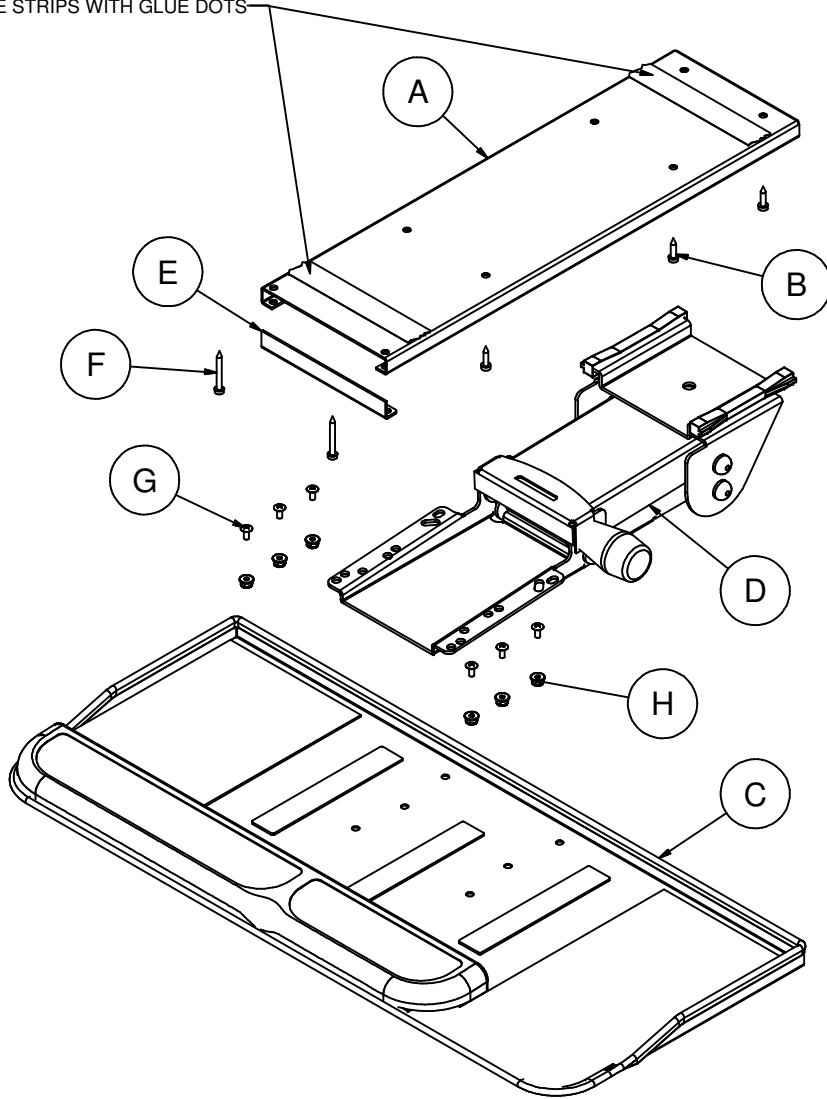

Parts List			
ITEM	QTY	DESCRIPTION	PART NUMBER
A	1	19" Track	N/A
B	6	#8 x 3/4 Pan Ph Quadrex PBS (Zinc)	080420041
C	1	Keyboard Tray	N/A
D	1	Arm Mechanism (100FP/S, 100FPHL/S)	N/A
E	1	Track Stop (Metal)	080420043
F	2	#8 X 1-1/2" Pan Ph Quadrex PBS (Black/OX)	080520041
G	6	8-32 X 3/8" Th Ph Ms (Black/OX)	081020041
H	6	8-32 Serr Fl Nut (Zinc)	081020042
J	2	Cord "D" Clip (not shown)	080520043

STEP 1: Mount (A) Track to bottom of worksurface as follows:
 a) Remove glue strips from track so glue dots are exposed.
 b) Position Track to be square and 1" back from the front edge of the worksurface. Press track firmly into position so glue dots support the Track under the worksurface.
 c) Drill 5/64" dia. by 3/4" deep pilot holes for Track.
 (NOTE: BE CAREFUL NOT TO DRILL THROUGH TOP OF DESK).
 d) Install (B) fasteners (six per track). Be sure not to over tighten screws.

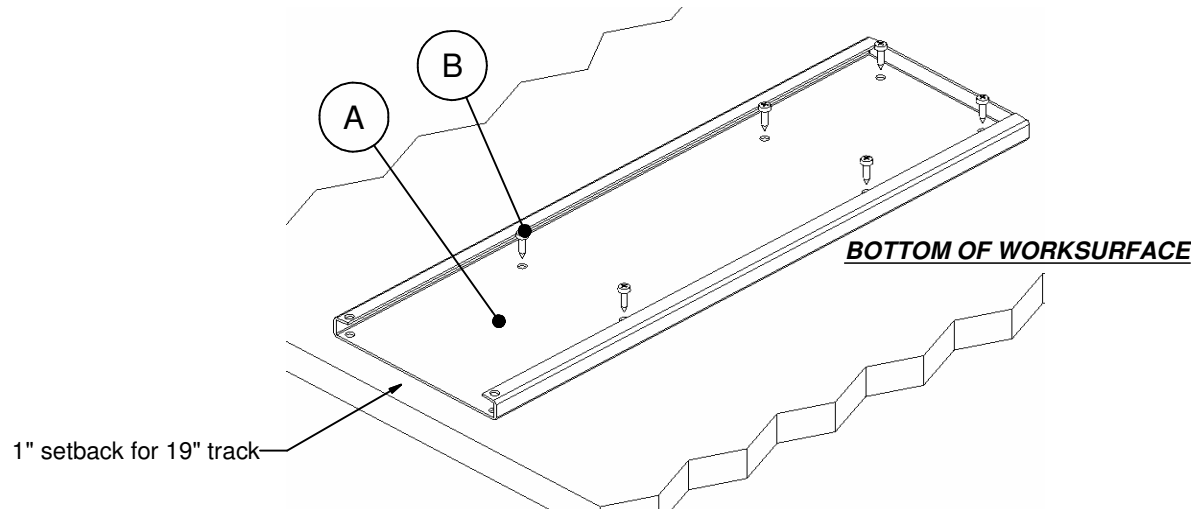

For questions or concerns, please call K & A Manufacturing, Inc.
 1-800-298-4351 available Monday-Friday 8:00 AM to 5:00 PM (Central Time)